

Before crimping

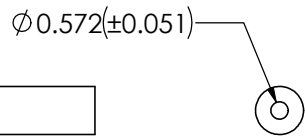

3.175(±0.381)

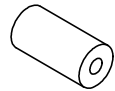
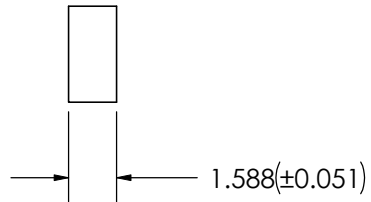

After crimping*

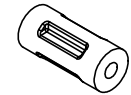

3.556(±0.381)

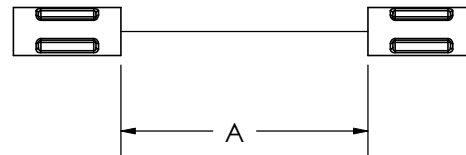

REFERENCE ONLY

*MAY CHANGE SLIGHTLY WITH DIFFERENT WIRE DIAMETERS
DOES NOT INCLUDE MINIMAL FLASH/DEFORMATIONS THAT ARE CREATED DURING CRIMPING



SCALE: 4:1

UNITS: mm

PROPRIETARY

THE INFORMATION CONTAINED IN THIS DRAWING IS THE SOLE PROPERTY OF DYNALLOY Inc. ANY REPRODUCTION IN PART OR AS A WHOLE WITHOUT THE WRITTEN PERMISSION OF DYNALLOY Inc IS PROHIBITED.

TITLE:		S.S. Barrel crimp	
FORM:		6975	
MATERIAL:	Stainless Steel	SHEET 1 OF 1	